

City Of Akron
Vol. 424 Pg. 074
P.N. 01-708946

Survey Reference Data

Surveys:
Reference Bearing N88°52'47"E Along The Centerline Of Bartholomew Rd. Taken From LaDue Highlands Subdivision Recorded In P.B. 28, Pg. 42
Survey For The City Of Akron Made By Environmental Design Group In Jan. 1993.
Deeds:
The Donald And Josephine May Trust Vol. 926 Pg. 435
The Donald And Josephine May Trust Vol. 926 Pg. 437
City Of Akron, Ohio Vol. 424 Pg. 74
City Of Akron, Ohio Vol. 395 Pg. 354
Bartholomew Road, Rd. Record Book "C" Pg. 66

Legend

- Iron Pin Found
- Concrete Monument Found
- 5/8" Iron Pin Set

Lacountria LTD
P.N. 01-118882
Vol. 1752 Pg. 1446
10.786 Ac. In Lot
0.122 Ac. In Ex. R/W
10.908 Ac. Total

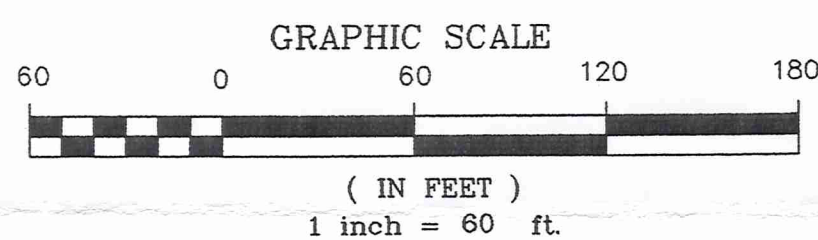
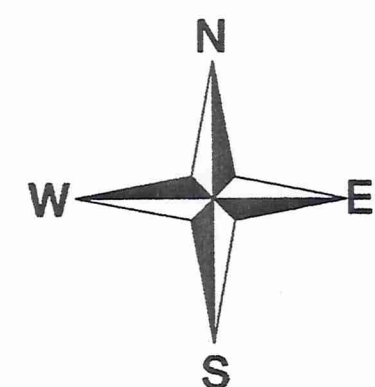

This drawing is a survey of a parcel of lands of Lacountria LTD, said land is situated in Lot 37, Tract 3, Auburn Twp. Geauga County and The State of Ohio, said survey was made at the request of Kevin Finnerty. I do hereby certify that I have surveyed the premises and prepared the attached drawing in accordance with the provisions of Chapter 4733-37 of The Ohio Administrative Code and dimensions of the parcel are in feet and decimal parts thereof, all of which are correct to the best of my knowledge and belief.

Jon D. Vollnogle 5-23-05
Jon D. Vollnogle Reg. Surveyor #7308 Date

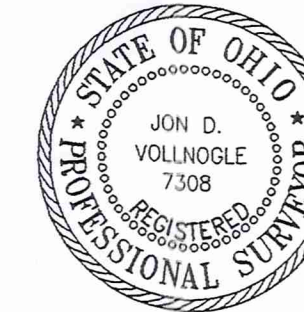

Lacountria LTD
P.N. 01-118881
Vol. 1752 Pg. 1446

Lacountria LTD
Part Of P.N. 01-118882
Vol. 1752 Pg. 1446
0.403 Ac. In Lot
0.001 Ac. In Ex. R/W
0.404 Ac. Total

Lacountria LTD
P.N. 01-118883
Vol. 1752 Pg. 1446
22.927 Ac. In Lot
0.638 Ac. In Ex. R/W
23.565 Ac. Total

SURVEY PLAT & LEGAL DESCRIPTION
APPROVED PER R.C. 315.251
A.S. *5/23/05*
OFFICE OF THE
Revised
GEAUGA COUNTY ENGINEER

REVISIONS

05-18-2005	
------------	--

DESIGNED BY: G.Z.L.
DRAWN BY: J.D.V.
CHECKED BY: J.D.V.
DATE: 04-13-2005
JOB NUMBER: 05-3010
FIELD BOOK: 426

Survey Of A Parcel Of Lands Of
Lacountria LTD
Lot 37, Tract 3, Auburn Township
Gauga County, State Of Ohio

Howells & Baird, Inc.
CIVIL ENGINEERS & SURVEYORS
SALEM, OHIO
PH. (330) 332-4834
FAX. (330) 332-4058



SCALE
1"=60'
SHEET
SA-2456B

AVB00132

LaCountria
picked up 5-26-05
Vol 1763 PG 1314
01-118918

Howells and Baird, Inc.

CIVIL ENGINEERS AND SURVEYORS
1156 East State Street
SALEM, OHIO 44460-2292

JON D. VOLLNOGLE, P.E., P.S.
President

JACK H. HOWELLS, P.E., P.S.
Business Development

PHONE (330) 332-4834
FAX NO. (330) 332-4058
E-MAIL: howbaird@neo.rr.com
DONALD L. BAIRD, P.E., P.S.
Vice President 1934 - 1995

25 May 2005

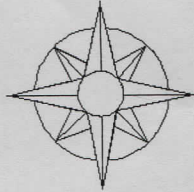

DESCRIPTION OF AN 0.404 ACRE PARCEL FOR LaCOUNTRIA, LTD.

Known as and being a parcel of land situated in Lot 37, Tract 3, Auburn Township, Geauga County, State of Ohio and being further bounded and described as follows:

Beginning for reference at a 5/8 inch iron pin found at the southwest corner of said Lot 37 in Auburn Township, Tract 3, said iron pin also being in the centerline of Bartholomew Road (a sixty foot right-of-way), said iron pin being N 88°-52'-47"E a distance of 1673.00 feet from a 3/4 inch rebar found at the intersection of the centerlines of Bartholomew Road and Auburn Road (a sixty foot right-of-way);

thence N 88°-52'-47"E (reference bearing) along the south line of said Lot 37, also being the centerline of said Bartholomew Road, a distance of 1340.61 feet to a 5/8 inch iron pin set at the southwest corner of lands owned by LaCountria, Ltd., Parcel #01-118883, as recorded in Volume 1752, Page 1446 of the Geauga County Deed Records, said iron pin being the true place of beginning of the tract herein described;

thence N 8°-00'-57"W a distance of 310.35 feet to a 5/8 inch iron pin set, but passing over a 5/8 inch iron pin set for reference at 30.22 feet;

thence N 0°-00'-00"W a distance of 220.00 feet to a 5/8 inch iron pin set;

thence N 90°-00'-00"E a distance of 150.55 feet to a 5/8 inch iron pin set on a westerly line of said Parcel #01-118883;

thence S 53°-28'-21"W along a westerly line of said Parcel #01-118883, a distance of 149.20 feet to a 5/8 inch iron pin set;

thence S 1°-38'-53"E along a west line of said Parcel #01-118883, a distance of 438.70 feet to a 5/8 inch iron pin set on the south line of said Lot 37, said iron pin also being on the centerline of Bartholomew Road to the place of beginning, but passing through a 5/8 inch iron pin set for reference at a distance of 408.70 feet, containing 0.404 acres of land, more or less, of which 0.001 acres lies in the existing right-of-way of Bartholomew Road.

The above described parcel also being subject to a 12 foot wide utility easement being adjacent to and 12 feet distant, northerly, and parallel to northerly right-of-way line of Bartholomew Road, said easement extends from the westerly line of the above described parcel to the easterly line of the above described parcel.

The above described parcel formerly being a part of a parcel owned by LaCountria, Ltd., as recorded in Volume 1752, Page 1446 of the Geauga County Records of Deeds.

This legal description was prepared by Jon D. Vollnogle, Registered Surveyor No. 7308 in May 2005 from a survey performed under his supervision.

Jon D. Vollnogle, Reg. Surveyor #7308

SEAL:

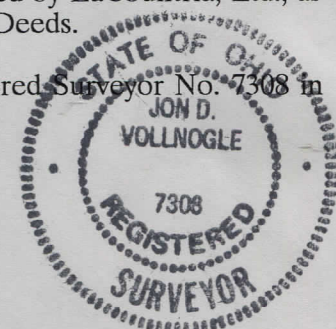

SURVEY PLAT & LEGAL DESCRIPTION
APPROVED PER R.C. 315.251
R.S. 5/26/05
OFFICE OF THE REVISOR
GEAUGA COUNTY ENGINEER